

The background of the image is a detailed architectural site plan and route map. It features various geometric shapes representing buildings, roads, and site boundaries. A prominent feature is a large rectangular area with a dashed line and the letters 'D/W' inside, possibly indicating a driveway or a specific site area. Other labels include 'B.O.', 'EP', 'F', and '10'0'. The drawing is in black lines on a light background, with a central orange rectangle overlaid containing the main title.

# SITE PLAN & ROUTE MAP

# Site Plan



# Floor Plans



BLOCK - A | 3RD TO 7TH FLOOR

TYPE	BHK	CARPET AREA	BALCONY AREA	PERIPHERY WALL AREA	BUA	SBUA
FLAT A	3	851 sqft	63 sqft	87 sqft	1001 sqft	1252 sqft
FLAT B	3	851 sqft	63 sqft	87 sqft	1001 sqft	1252 sqft
FLAT C	3	1018 sqft	108 sqft	88 sqft	1214 sqft	1519 sqft
FLAT D	3	851 sqft	63 sqft	87 sqft	1001 sqft	1252 sqft
FLAT E	3	851 sqft	63 sqft	87 sqft	1001 sqft	1252 sqft

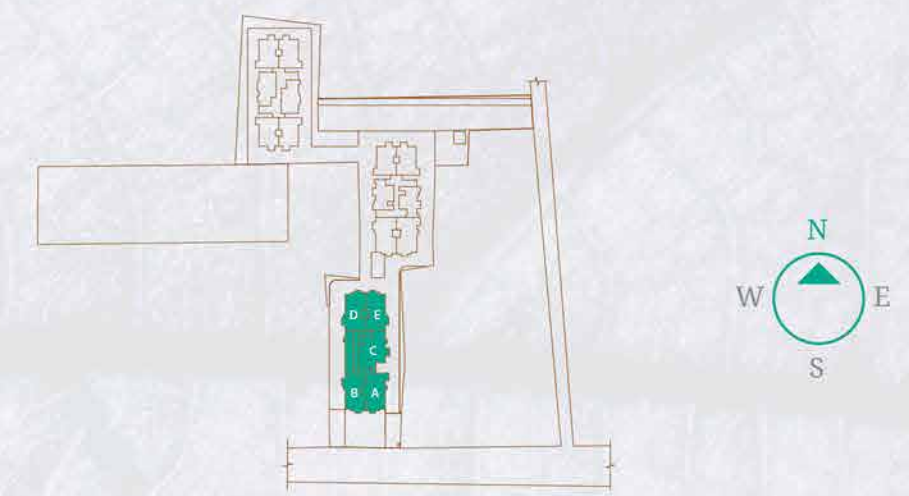



### The Address of Peace The Location Of Buzz

Uttarayan Shreejoni is at premium location on 110 ft wide Dharapur Palashbari Road with an approach from Jalukbari & New Airport Road. "TERAPANTHI BHAWAN", for Jain people is on the bang opposite of the Project.



Airport

Terapanthi Bhawan

Deepor Beel



- Premium English Medium Schools / Don Bosco College/ Govt. College/ Other Educational Institutes - 2 Kms Radius
- Proposed New Terminal of LGBI Airport - 2 Kms Drive  
Present Airport Terminal - 4.3 Kms
- Assam Engineering College - 5 Kms

- Railway Station - 15 Mins Drive
- ISBT - 20 Mins Drive
- Gauhati University - 7 Mins Drive

